

# AMERICAN AVK SERIES 2780 HIGH PRESSURE DRY BARREL HYDRANT 6" DIPS & IPS POLYETHYLENE PIPE END BASE

**NOSTALGIC**

Meets or exceeds AWWA C502 ( latest )  
Working pressure - 250 PSI

Inlet Base:  
Pipe: PE 3408  
Pipe Stubs meet or exceed AWWA C906 SDR 9, SDR 11, SDR 13.5.  
DIPS or IPS suitable for butt fusion or electro fusion joining.

**Tests:**

Shell Test: 500 PSI    Seat Tests: 50 PSI and 250 PSI    Operating Torque Test



**Components:**

Barrel Gasket, Cap Gasket, O-rings  
Lubrication Hole Seal  
Bonnet, Nozzle Section, Barrels, Standpipe Flanges,  
Breakable Flange, Main Valve Flange, Base  
Caps, Weathershield  
Nozzles, Valve Seat Ring, Drain Ring,  
Brass Fittings, Brass Plugs, Operating Nut, Thrust Nut,  
Stem Bushing  
Anti Friction Washer  
Coating

**Main Valve**

Stem Rod Couplings, Lock Rings, Nozzle Retaining Screw  
Lock Plate, Lock Plate Screw, Spider Bolt  
Stop Pins, Coupler Pins, Main Valve Retaining Pin,  
Spring Pins  
Stop Nut, Chain Set,  
Base Configuration

**Hardware**

Upper and Lower Stem Rods  
Opening Direction

**Standard:**

NBR  
Oil Resistant Rubber  
Ductile Iron ASTM A536

Cast Iron ASTM A126 Class "B"  
Bronze/Brass

**Polymide**

Above ground-Fusion bonded Epoxy inside  
and out. Below ground-Bitumen/Fusion  
bonded Epoxy. Epoxy meets or exceeds  
AWWA C550 ( latest )

Ductile Iron core fully encapsulated  
with EPDM Rubber  
Stainless Steel

Zinc Plated Steel  
6" PE

Zinc Plated Steel     304     316 Stainless  
 Epoxy Coated Steel     Stainless Steel  
 Open Left     Open Right

**Optional:**

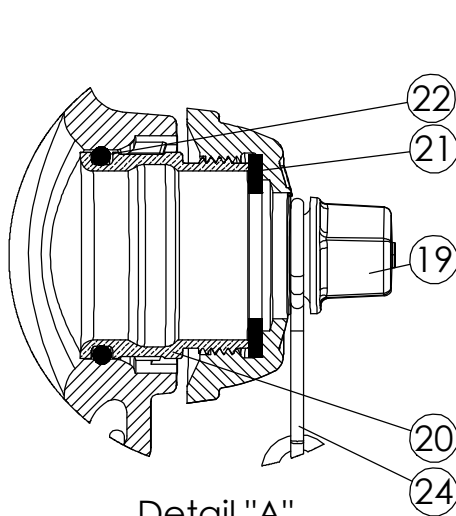

Detail "A"

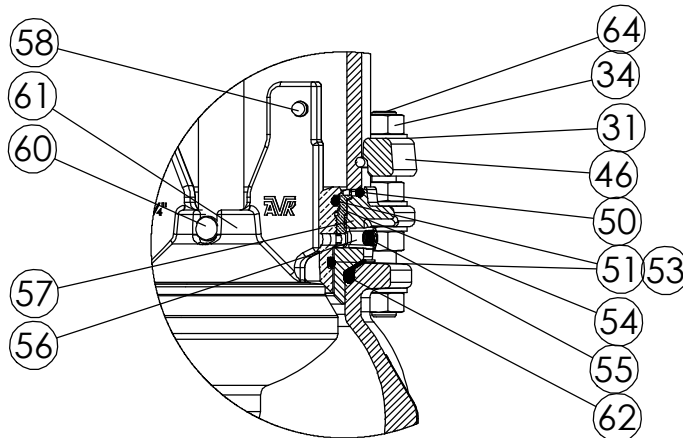

Detail "B"



**SERIES 2780 DRY BARREL HYDRANT  
SPECIFICATION ( PE BASE )**

Subject to change without notice  
American AVK / Rev. A 05/15/02

# AMERICAN AVK SERIES 2780 HIGH PRESSURE DRY BARREL HYDRANT 6" DIPS & IPS POLYETHYLENE PIPE END BASE

**NOSTALGIC**

Meets or exceeds AWWA C502 ( latest )  
Working pressure - 250 PSI

Inlet Base:

Pipe: PE 3408

Pipe Stubs meet or exceed AWWA C906 SDR 9, SDR 11, SDR 13.5.  
DIPS or IPS suitable for butt fusion or electro fusion joining.

## Component List

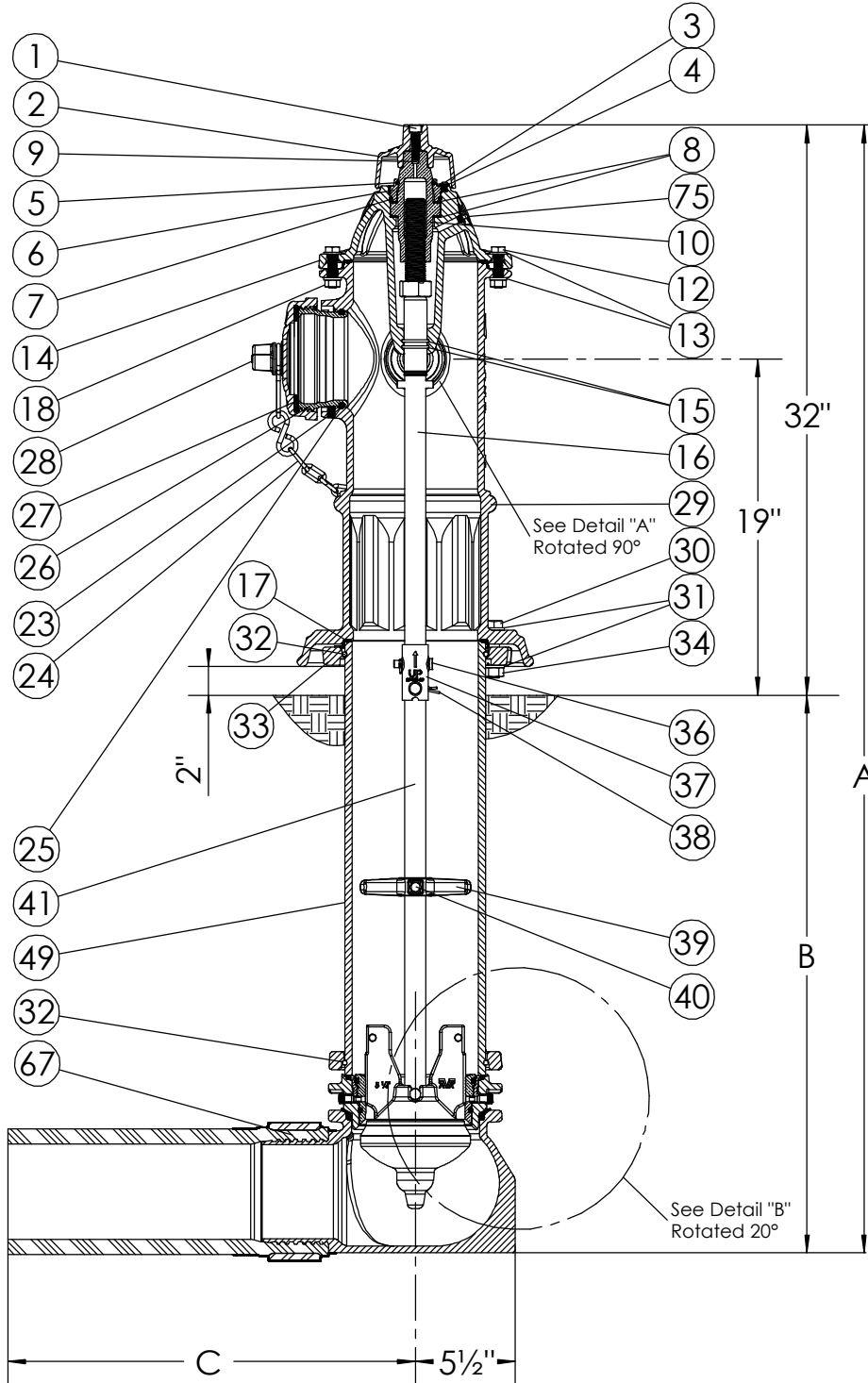

1. Weathershield Bolt
2. Weathershield
3. Lock Plate Screw
4. Lock Plate
5. Inner Thrust Nut O-ring
6. Thrust Nut
7. Outer Thrust Nut O-ring
8. Anti-Friction Washer
9. Lubrication Hole Seal
10. Operating Nut
11. Stop Nut
12. Bonne Bolt
13. Bonnet Washer
14. Bonnet
15. Stem Seal O-rings
16. Upper Stem Rod
17. Barrel Gasket
18. Bonnet Nut
19. Hose Nozzle Cap -Detail A
20. Hose Nozzle -Detail A
21. Hose Nozzle Cap Gasket -Detail A
22. Hose Nozzle O-ring -Detail A
23. Nozzle Retaining Screw
24. Chain Set -Detail A
25. Pumper Nozzle O-ring
26. Pumper Nozzle
27. Pumper Nozzle Gasket
28. Pumper Cap
29. Nozzle Section
30. Nozzle Section Bolt
31. Nozzle Section Washer
32. Lock Ring
33. Breakable Flange
34. Nozzle Section Nut
36. Coupler Pin
37. Breakable Stem Rod Coupling
38. Spring Pin
39. Spider
40. Spider Bolt
41. Lower Stem Rod
46. Standpipe Flange -Detail B
49. Lower Barrel
50. Lower Barrel O-ring -Detail B
51. Valve Seat O-ring -Detail B
53. Valve Seat O-ring -Detail B
54. Drain Ring -Detail B
55. Brass Plug -Detail B
56. Brass Fitting -Detail B
57. Main Valve Flange -Detail B
58. Stop Pin -Detail B
60. Main Valve Retaining Pin -Detail B
61. Main Valve Disc -Detail B
62. Base Gasket -Detail B
64. Stud Bolt -Detail B
67. Base
75. Zerk Fitting

Ref. Nos.	Nozzles	A	B	C
27-80	2 Hose Outlet, 1 Pumper	49" - 182"	18" - 150"	22.5"